

## Technical Data Sheet MOY BS-4,8 Fastener

### Product Use:

4,8mm diameter carbon steel fastener for waterproof membrane and insulation securement on steel and timber decks\*.

To be used in conjunction with the appropriate stress plates or thermally broken sleeves.

### Description:

Case hardened carbon steel. Durocoat® corrosion protection. Resistance 15 cycles Kesternich test according to:

- EAD 030351-00-0402, A2.4
- FM Approval Standard 4470

### Features and Benefits:

- Fast and easy installation due to optimised drill tip
- High pull-out values with asymmetric fastener thread
- High quality corrosion protection, environmentally friendly, free of Chromium VI
- Universal sleeve suitable for compatible *isotak*® fasteners
- FM approved with exceptional high ratings

### Certification:

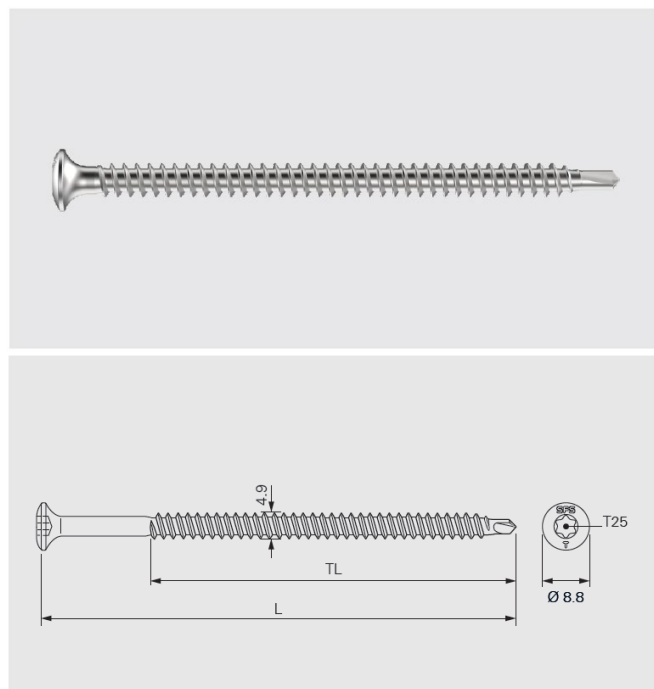
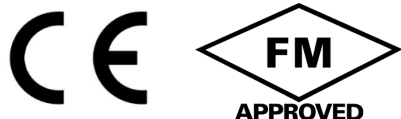

### Fastener Product Range:





Code	L <sub>mm</sub>	TL <sub>mm</sub>	Pack Quantity	Article Code
BS-4,8×50	50	45	1000	1261131
BS-4,8×60	60	55	500	1261132
BS-4,8×70	70	65	500	1261140
BS-4,8×80	80	75	500	1261142
BS-4,8×90	90	75	500	1261143
BS-4,8×100	100	75	500	1261144
BS-4,8×110	110	75	500	1261145
BS-4,8×120	120	75	500	1261146
BS-4,8×130	130	75	500	1261148
BS-4,8×140	140	75	500	1261149
BS-4,8×150	150	75	500	1261150
BS-4,8×170	170	75	250	1261151
BS-4,8×190	190	75	250	1261152
BS-4,8×200	200	75	250	1261153
BS-4,8×220	220	75	250	1261154
BS-4,8×240	240	75	250	1261155
BS-4,8×260	260	75	250	1261156
BS-4,8×300	300	75	250	1261157

Packaging type: plastic bucket

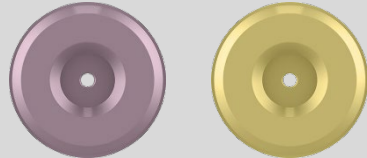

## Technical Data Sheet MOY BS-4,8 Fastener

### Products to combine with:

Product Code	Description	
FI-P-6,8	Stress plates for PVC and TPO based waterproof membranes.  For isoweld® field fastening application.	
R48	Sleeve with 3 peaks for waterproof membrane securement.  For seam fastening application.	
R50	Sleeve for waterproof membrane securement.  For seam fastening application.	
R75	Sleeve for insulation securement.	
FI-R-20	Sleeve for waterproof membrane and insulation securement.  For isoweld® field fastening and seam fastening applications.  For use with compatible steel termination bars.	

### Installation:

In order to ensure the correct application of the tube & fastener combination into the substrate and to avoid overdriving and/or damage, all sleeves and fasteners must be installed using only the recommended tooling, including screw guns (with torque setting), drive bars and correct bits etc.

It is recommended that pull-out testing is undertaken by SFS for all refurbishment projects. This will ensure the suitability of the fastener and additionally will determine the optimum drill diameter and embedment required.

#### \*Application into steel:

Substrate material quality: S235-S320GD  
 Substrate material thickness: min. 0.6 mm  
 max. 2x1.25 mm or 1x2.0 mm  
 Setting depth: min. 20 mm

#### \*Application into timber & timber-based boards:

Substrate material thickness: min. 18 mm  
 Setting depth: min. 30 mm

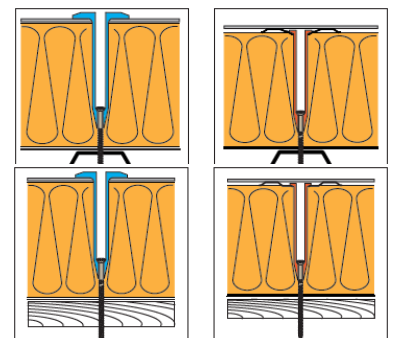

MOY Materials Ltd has taken care to ensure that the information provided in the literature is correct and up to date. However, it is not intended to form any part of a contract or provide a guarantee. Purchasers/intending purchasers should contact MOY Technical to check whether there have been any changes to the information since publication of the literature. Please ensure you have read the hazard labels and material safety data sheet before using this product.