

Technical Data Sheet MOY BS-S-4,8 Fastener

Product Use:

4,8mm diameter austenitic stainless steel fastener for waterproof membrane and insulation securement on steel and timber decks*.

To be used in conjunction with the appropriate stress plates or thermally broken sleeves.

For use where the internal relative humidity is in excess of 65% or for chemically aggressive atmospheres or conditions. For example, coastal conditions.

Ideal for use in refurbishment applications where the detailed condition of the existing roof is not known or when the build-up contains abrasive layers that may damage the corrosion protection of carbon steel fasteners and make them ineffective.

For applications where an extended design life and warranty is required.

Description:

Austenitic stainless steel, European standard 1.4401, grade A4, AISI 316. Drill tip and thread inlet, length 13 mm: Case hardened carbon steel, galvanised.

Features and Benefits:

- Stainless steel quality A4, 1.4401, AISI 316
- Fast and easy installation due to optimised drill tip
- High pull-out values with asymmetric fastener thread
- Environmentally friendly, free of Chromium VI

Certification:



Fastener Product Range:



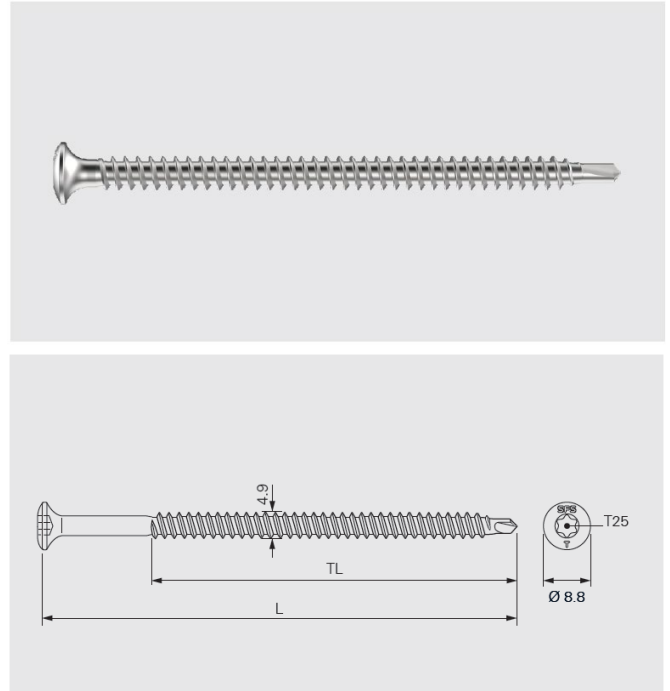

Code	L _{mm}	T _{mm}	Pack Quantity	Article Code
BS-S-4,8×60	60	55	250	1341595
BS-S-4,8×80	80	75	250	1341596
BS-S-4,8×100	100	75	250	1341587
BS-S-4,8×120	120	75	250	1341588
BS-S-4,8×140	140	75	250	1341589
BS-S-4,8×160	160	75	250	1341591
BS-S-4,8×180	180	75	250	1341593
BS-S-4,8×200	200	75	250	1341594

Packaging type: cardboard box

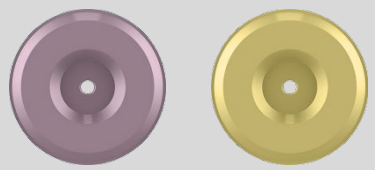

Technical Data Sheet MOY BS-S-4,8 Fastener

Products to combine with:

Product Code	Description	
FI-P-6,8	Stress plates for PVC and TPO based waterproof membranes. For isoweld® field fastening application.	
R48	Sleeve with 3 peaks for waterproof membrane securement. For seam fastening application.	
R50	Sleeve for waterproof membrane securement. For seam fastening application.	
R75	Sleeve for insulation securement.	
FI-R-20	Sleeve for waterproof membrane and insulation securement. For isoweld® field fastening and seam fastening applications. For use with compatible steel termination bars.	

Installation:

In order to ensure the correct application of the tube & fastener combination into the substrate and to avoid overdriving and/or damage, all sleeves and fasteners must be installed using only the recommended tooling, including screw guns (with torque setting), drive bars and correct bits etc.

It is recommended that pull-out testing is undertaken by SFS for all refurbishment projects. This will ensure the suitability of the fastener and additionally will determine the optimum drill diameter and embedment required.

*Application into steel:

Substrate material quality: S235-S320GD
 Substrate material thickness: min. 0.6 mm
 max. 2x1.0 mm
 Setting depth: min. 20 mm

*Application into timber & timber-based boards:

Substrate material thickness: min. 18 mm
 Setting depth: min. 30 mm

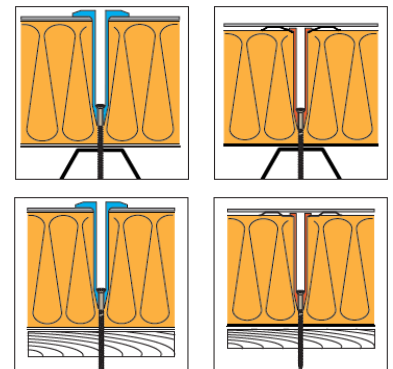

MOY Materials Ltd has taken care to ensure that the information provided in the literature is correct and up to date. However, it is not intended to form any part of a contract or provide a guarantee. Purchasers/intending purchasers should contact MOY Technical to check whether there have been any changes to the information since publication of the literature. Please ensure you have read the hazard labels and material safety data sheet before using this product.