

Technical Data Sheet Guardian BS 4.8mm Fastener

Product Use:

4.8mm diameter coated carbon steel roofing fastener for use with the Guardian tube system, suitable for securing insulation and membrane to steel decks.

Description:

- For use with Guardian tube system.
- Fixing insulation & membrane to steel decks (0.7mm to 1.25mm thick).
- Torx 25 drive head.
- Drill point (drilling capacity 2 x 1.25mm).
- Packed in buckets.
- ETA Approval 08/0285.
- Enduroguard coating, 15 cycles.
- FM Approval No. 3034551.



Technical Specification:

Code	Description
19-BS-48050	4.8 x 50mm Guardian BS Roofing Screw
19-BS-48060	4.8 x 60mm Guardian BS Roofing Screw
19-BS-48070	4.8 x 70mm Guardian BS Roofing Screw
19-BS-48080	4.8 x 80mm Guardian BS Roofing Screw
19-BS-48090	4.8 x 90mm Guardian BS Roofing Screw
19-BS-48100	4.8 x 100mm Guardian BS Roofing Screw
19-BS-48110	4.8 x 110mm Guardian BS Roofing Screw
19-BS-48120	4.8 x 120mm Guardian BS Roofing Screw
19-BS-48130	4.8 x 130mm Guardian BS Roofing Screw
19-BS-48140	4.8 x 140mm Guardian BS Roofing Screw
19-BS-48150	4.8 x 150mm Guardian BS Roofing Screw
19-BS-48170	4.8 x 170mm Guardian BS Roofing Screw
19-BS-48190	4.8 x 190mm Guardian BS Roofing Screw

Substrate	Pull-Out Value
Steel 0.75mm	1.6kN
Steel 1.00mm	2.0kN

Based on 20mm Fastener Penetration

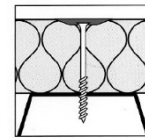

Certification:



Suitable Tubes:

The BS fasteners can be combined with the following from the Guardian tube range:

R75 Standard ✓
(fixing insulation or underlays)



R45 Standard ✓
(fixing membrane in the overlap)



RB48 Standard Barbed ✓
(fixing membrane in the overlap)





Technical Data Sheet Guardian BS 4.8mm Fastener

Installation:

In order to ensure the correct application of the tube & fastener combination into the substrate and to avoid overdriving and/or damage, all sleeves and fasteners must be installed using only the recommended tooling, including screw guns (with torque setting), drive bars and correct bits etc.

A project specific wind uplift calculation should be carried out to ensure the correct density of fasteners is installed. Pull-out testing should also be undertaken for all refurbishment projects.