

Technical Data Sheet Paraflex ARD/S

Product Description / Use:

Paraflex ARD/S is a modified bitumen SBS polymer waterproofing membrane intended for all waterproofing applications including; Flat Roofs, Terraces, Podiums, Car Parks and Bridge Decks, Tunnels, Foundations and Underground Structures.

The Paraflex range of waterproofing membranes, is FM approved and may be used in new build and refurbishment applications and is suitable for application in low temperature conditions. Paraflex remains flexible at low temperatures and exhibits high resistance to thermal stress.

Paraflex ARD/S is manufactured with a mineral slate or mineral stone granule coating to the upper surface of the membrane in various colours, offering UV protection and slip resistance. The membrane compound is reinforced with a synthetic non-woven continuous filament polyester fabric, enabling plasticity, elastic behaviour and superior resistance to mechanical damage. The lower face is coated with Termotene® fusible film which aids unrolling and facilitates torch bonding to various substrates.

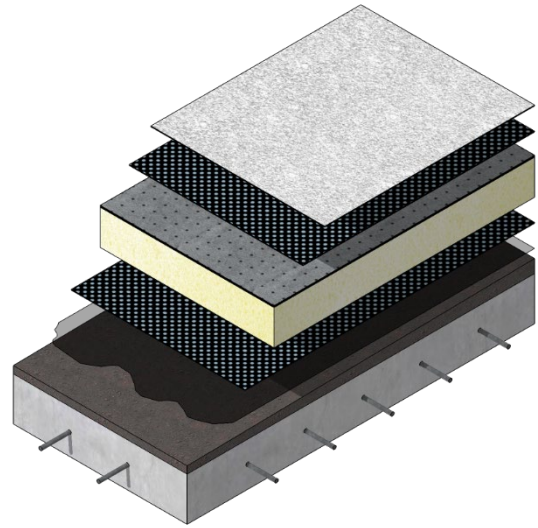

The Paraflex SBS bitumen compound's special formulation ensures high mechanical performance, cold flexibility at temperatures down to -25°C and excellent fatigue strength.

Paraflex membranes contain no asbestos, tar or other dangerous substances.

Certification:



NSAI



System Fire Testing:

Classification Standard BS EN 13501-5: 2016
Test Standard: CEN/TS 1187:2012

warringtonfire

Determination of external fire performance is a system test which will be influenced by the components within the roofing system.

Whilst Paraflex ARD/S can be included in compliant B_{ROOF (t4)} systems, always check with MOY Technical Services for the very latest information on fire testing carried out.



Technical Data Sheet Paraflex ARD/S

Technical Specification:

Specifications	EN Standards	Unit of Measure	Tolerances ⁽¹⁾	Paraflex ARD/S ^(2,10)
Roll dimensions	1848-1	m	≥	8 x 1 (-1%)
Thickness	1849-1	mm	±5%	-
Mass per unit area	1849-1	kg/m ²	±10%	4.5
Watertightness	1928-B	kPa	≥	60
Cold flexibility	1109	°C	≤	-25
Flow resistance at elevated temperature	1110	°C	≥	+100
L/T tensile strength	12311-1	N/5cm	±20%	800/600
L/T tensile elongation	12311-1	%	±15 ⁽³⁾	50/50
L/T dimensional stability	1107-1	%	±2	0.3
Static puncture	12730	kg	≥	NPD ⁽⁴⁾
Dynamic puncture	12691-B	mm	≥	1250
L/T tear resistance	12310-1	N	±30%	160/180
Joint peel resistance	12316-1	N/5cm	±20 N	NPD ⁽⁴⁾
Joint cut resistance	12317-1	N/5cm	±20%	NPD ⁽⁴⁾
Durability after ageing:				
• Cold flexibility	1296-1109	°C	+15°C	-10
• Flow resistance at elevated temperature	1296-1110	°C	-10°C	+100
• UV Ageing	1297	-	-	NPD ⁽⁴⁾
• Watertightness	1296-1928	kPa	≥	60
• Chemical resistance	-	-	-	NPD ⁽⁴⁾
• L/T tensile strength	12311-1	N/5cm	±20%	700/500
• L/T tensile elongation	12311-1	%	±15 ⁽³⁾	45/45
Steam permeability	1931	μ	≥	20,000
Root resistance	13948		-	NPD ⁽⁴⁾
External fire behaviour	13501-5	EC ⁽⁶⁾	-	NPD ⁽⁹⁾
Fire reaction	13501-1	EC ⁽⁶⁾	-	F
Solar Reflectance Index (SRI)	ASTM Standard E1980	%	-	82.1 ⁽⁸⁾

Notes:

- (1) In compliance with the applicable AISPEC/SITEB-MBP Guidelines.
- (2) Upper finish in slate flakes standard colour Natural grey. Other colours may be available upon request Red, Green, White Reflecta.
- (3) ±2 for Glass Mat reinforcements.
- (4) Characteristic not determined because it is not relevant for use.
- (5) RFG: Failure away from joint. Or ≥ 500.
- (6) Euroclass.
- (7) Internal report
- (8) Only Reflecta White version, in heavy wind conditions
- (9) Determination of external fire performance is a system test which can be influenced by system components, thus performance for each individual product cannot be given.
- (10) Variation in coating between mineral slate flake and mineral stone granules may occur between batches.

Colour:

Paraflex ARD/S is available in a range of colours. Standard colours are Anthracite and Slate Grey. Other colours are available upon request; Red, Green, Bianco Reflecta. Some shade variation in colours may occur between rolls.

Technical Data Sheet Paraflex ARD/S

Delivery form:

Rolls.

Storage:

Rolls must be stored in their original package, in vertical position and under cool and dry conditions between temperatures of +5 °C and +35 °C. They must be protected from direct sunlight, rain, snow and ice.

Shelf life:

They can be stored for up to 24 months in cool, dry conditions.

Safety:

Safety precautions to be taken when using this product is given in the Safety Data Sheet.

Disposal:

Information for this product is given in the Safety Data Sheet.