

## Technical Data Sheet

### Spray-Applied PU Insulation Adhesive (Q3000)

#### Description:

MOY PU Spray-Applied Insulation Adhesive is a single-part moisture-cure urethane foam adhesive designed specifically for bonding flat roofing insulation such as polyisocyanurate (PIR), or mineral wool boards to a variety of roof decks, including concrete, plywood and cementitious boards and, common air and vapour control layers (AVCL's) such as bituminous or self-adhesive foil faced modified membranes. This adhesive also works with EPS or XPS (expanded or extruded polystyrene) insulation. It replaces the need for traditional screw fasteners that would be secured through the roofing system.

#### Benefits:

- Full finger trigger movement.
- Uplift tested to 9kN
- Fully portable.
- Fully sealed system.

#### Substrates:

Suitable for\*:

*Concrete, timber, tissue-faced PIR, mineral wool, EPS, XPS, bitumen-based waterproofing, foil faced modified bitumen AVCL's.*

Substrate quality: The substrate must be solid and in a suitable condition prior to adhering and be able to resist any wind forces.

\* Adhesion tests should be carried out prior to use. Applications only for substrates and membranes listed. All others should be tested prior to use. Primer may or may not be required to ensure a successful bond.

Please contact MOY Technical Services for further guidance.

#### Certification:



#### Technical data:

Shelf Life:	9 Months
Appearance:	Green
Temperature Resistance:	-30°C - 160°C
Solvent System:	Polymeric Diphenylmethane Diisocyanate
Coverage:	160m <sup>2</sup> (13.7 ltr) - 350m <sup>2</sup> (22 ltr)
Solids:	100%
VOC Content:	Less than 160g/ltr
Storage:	5°C - 25°C



## Technical Data Sheet

### Spray-Applied PU Insulation Adhesive (Q3000)

#### Application:

Application type:	1-sided spray applied.
Open time:	10 mins.
Flash-off time:	5 mins.
Spray type:	Foam beaded.
Gun type:	Bead Gun
Hose type(s):	4m S/S Braided c/w valve 8m S/S Braided c/w valve
Square metre coverage:	22ltr = 350m <sup>2</sup> / 13.7ltr = 160m <sup>2</sup>

- This product is designed to be applied to the roof deck. For best results, the temperature of the adhesive and the surfaces being bonded should be between 16°C - 27°C.
- Use with adequate ventilation. When possible we recommend shaking the canister well before using.
- Attach and secure hose tightly onto the spray gun with required tip. Attach the other end of the hose onto the canister. Make sure the hose-valve connections are securely tight. Open the valve on the canister slowly and fully, check for leaks during this process. Unlock the trigger on the spray gun to start spraying.
- Prior to use, check compatibility by spraying a small test patch of the adhesive on the substrate. This product may degrade some substrates.

1. Make sure that surfaces are clean, dry and free from dirt, dust, oil, loose paint, wax or grease, etc



2. Bead about 10-20 cm away at a 45° angle to the surface, applying a consistent 20-40mm wide bead every 300mm, doubling up this rate at perimeter edges.

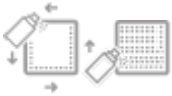

3. Place insulation boards onto beads of adhesive immediately without pressure.

4. Wait 5 minutes for adhesive to set, before walking insulation board in.



5. If the spray tip clogs, unscrew the spray tip from the gun and clean with solvent such as lacquer thinner or acetone. Do not use a pin on the spray tip

## Technical Data Sheet

### Spray-Applied PU Insulation Adhesive (Q3000)

#### **Temperature and timings:**

All information on temperature and timings represent normal working conditions and is provided as a guideline only. However, please contact MOY Technical Services for advice if you wish to operate outside of these parameters.

#### **Storage & Handling:**

- Consult Safety Data Sheet prior to use.
- DO NOT store at temperatures over 50°C.
- Avoid exposure to direct sunlight.
- DO NOT store directly on concrete floor.
- For optimum performance, store at 18°C during use, but must always be above 10°C.
- When connected, keep valve open and hose pressurised at all times.
- DO NOT close valve until ready to connect to new cylinder.
- Release pressure in hose before disconnection.
- Always test product to determine suitability for your particular application prior to use in production.

#### **Canister Storage/Changeover:**

Turn valve on canister into the OFF position, spray out remaining adhesive left in the hose, disconnect the spray hose and gun from the canister. Reconnect the spray hose to a canister of cleaning solvent (sold separately) and spray out until liquid is clear which indicates that the hose and gun is clean.

If you choose to leave the hose and spray gun on the canister, leave the valve on the canister OPEN. Do not disconnect the hose/gun from the canister. CLOSE and LOCK the spray gun.

#### **Disposal:**

Information for this product is given in the Safety Data Sheet.